

# Rubber Fenders

## CY Fender

CY Fender is a simple hollow cylinder which generally is mounted on the small scale of the quays for the small and medium vessels. It gives a small hull pressure to the vessel by taking large deformation when the vessel comes alongside the quay.

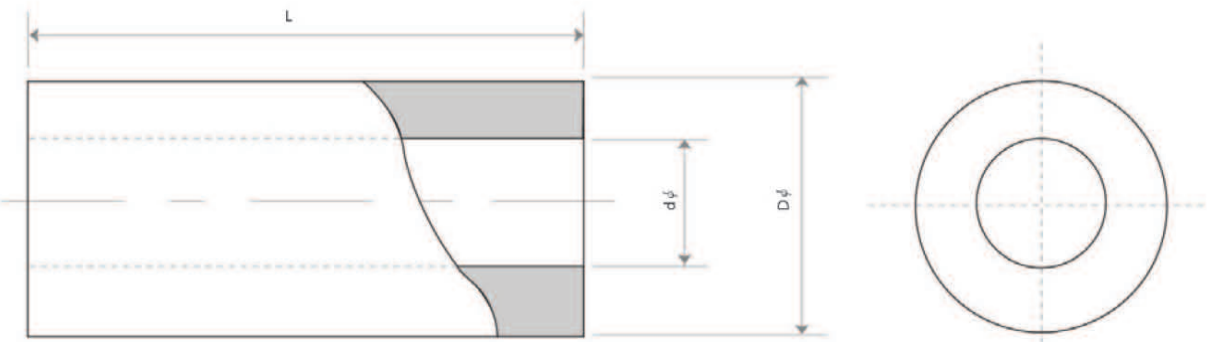

(Unit : mm)

Size	Cy150 φ × 75 φ	Cy200 φ × 100 φ	Cy300 φ × 150 φ	Cy400 φ × 200 φ	Cy500 φ × 250 φ	Cy600 φ × 300 φ	Cy800 φ × 400 φ	Cy1000 φ × 500 φ	Cy1200 φ × 600 φ	Cy1400 φ × 700 φ	Cy1600 φ × 800 φ
Dφ	150	200	300	400	500	600	800	1000	1200	1400	1600
dφ	75	100	150	200	250	300	400	500	600	700	800

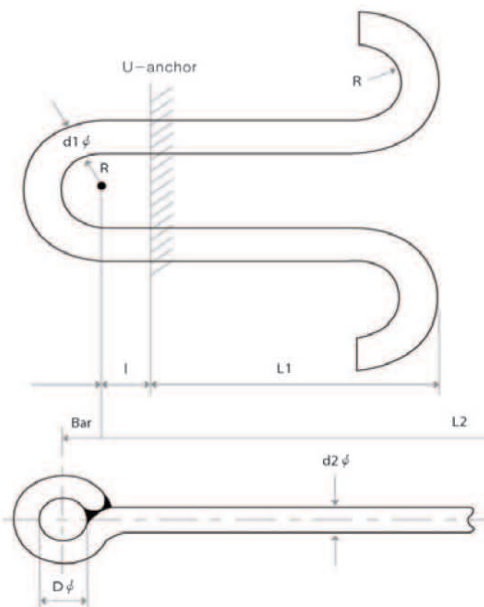

### • Fitting Chain and Bar

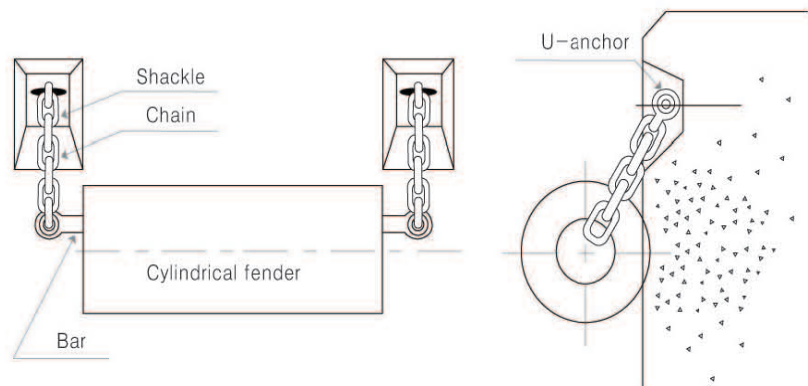

# Rubber Fenders

### • Performance Curve

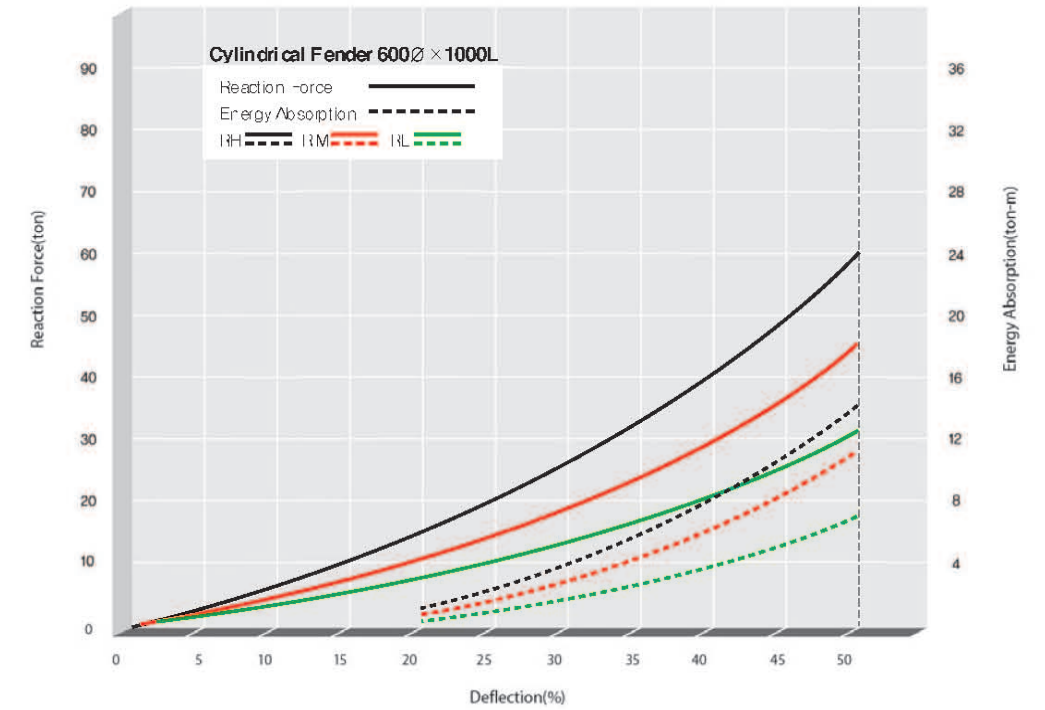

### • Cylindrical Fender Performance Table

Size	(1m Length)											
	150 φ × 75 φ	200 φ × 100 φ	300 φ × 150 φ	400 φ × 200 φ	500 φ × 250 φ	600 φ × 300 φ	800 φ × 400 φ	1000 φ × 500 φ	1200 φ × 600 φ	1400 φ × 700 φ	1600 φ × 800 φ	
RH	R · F(ton)	7.50	10.00	15.00	20.00	25.00	30.00	40.00	50.00	60.00	70.00	80.00
	E · A(ton-m)	0.22	0.40	0.90	1.60	2.50	3.60	6.40	10.00	14.40	19.60	25.60
RM	R · F(ton)	6.00	7.70	12.00	16.00	19.00	23.00	30.00	38.00	46.00	54.00	61.00
	E · A(ton-m)	0.18	0.32	0.73	1.30	2.00	2.90	5.20	8.20	11.70	15.90	20.80
RL	R · F(ton)	4.10	5.40	8.00	11.00	13.00	16.00	21.00	26.00	32.00	37.00	42.00
	E · A(ton-m)	0.12	0.21	0.48	0.84	1.32	1.90	3.40	5.30	7.60	10.40	13.50

- R · F : Reaction Force(ton) - E · A : Energy Absorption(ton-m) - Tolerance : ±10% - Deflection : 50%

### • Cylindrical Fender Compression Test

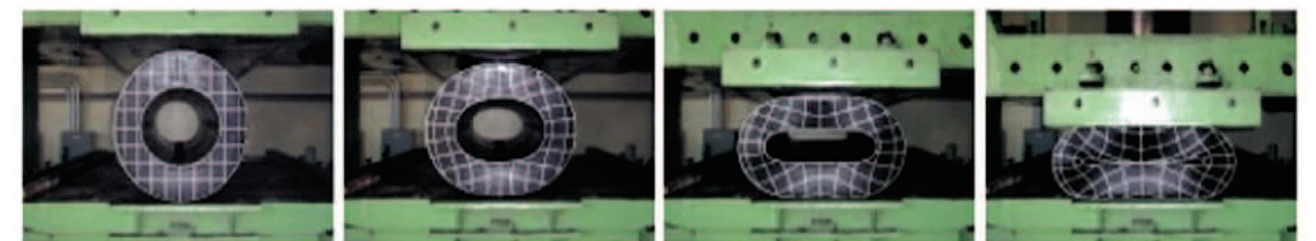

Deflection 0%

Deflection 15%

Deflection 30%

Deflection 50%